

Section A-A

The stall construction is to supported to the ceiling with steel wire.

Walls in the milking parlour must be reinforced solid concrete walls.

Min. height on detached wall = 2200mm

Bearing pipe

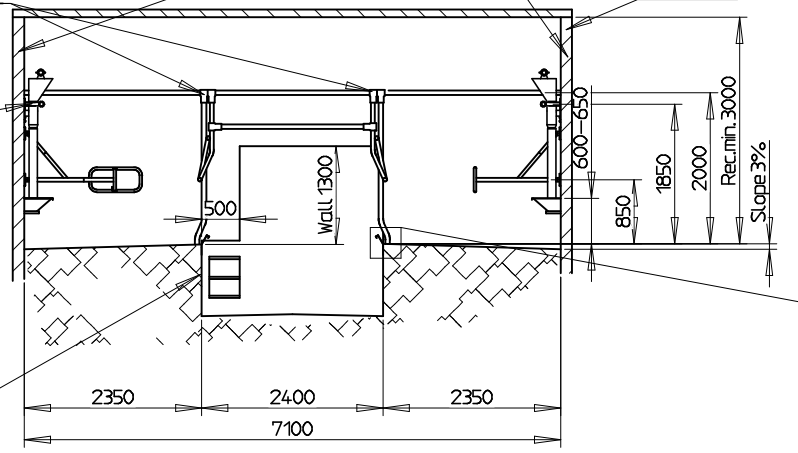

Walls in the milk pit must be vertical

Stainless steel edge

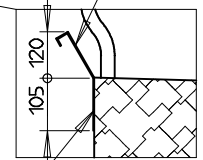

Stainless steel edge is to be bolted to the edge.

Please note!  
Ventilation:  
 During building up there must be provided the necessary ventilation to prevent condensed water in the milking parlour.

The walls of the milking Parlour, on which you mount the stall construction must be flat. No posts, rafters etc. are allowed as they might obstruct to the cows.

All measures in mm

STRANGKO A/S		Tolerance:	Overload:	Målestok: 1:50	Vægt:
HORNE, DK-6800 VARDE				Materiale:	
Tlf. +4575260211				Dimension:	
				Beskrivelse:	
				Milking Parlour 2x10 Parallel side exit, with feeding	
				Tegningsnummer:	05 210 017 01
					Sider: 1
A	Rev.tegning	10.02.04	ja		
Rev.	Retteset	Data	Navn	Original:	Erh. f.:
					Beskriv: