

Section A-A

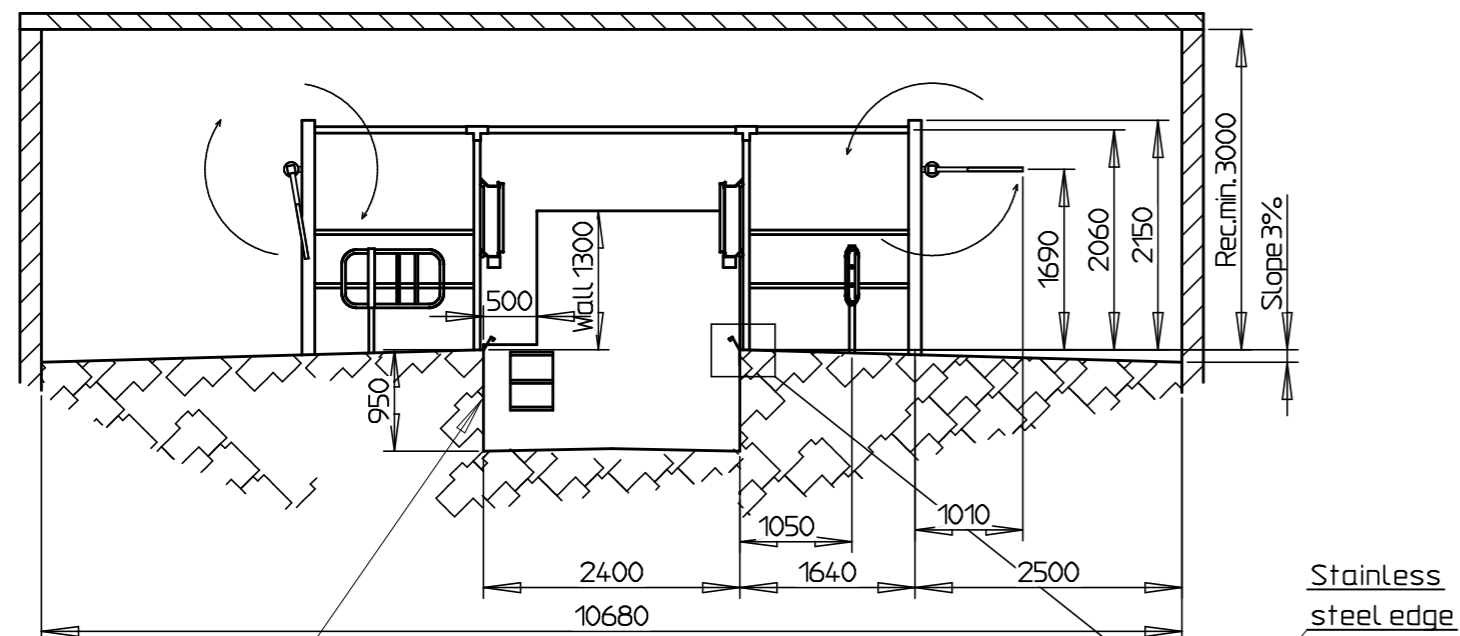

Walls in the milk pit must be vertical

Stainless steel edge is to be bolted to the edge.

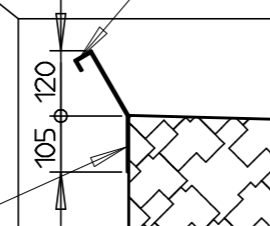

Section B-B

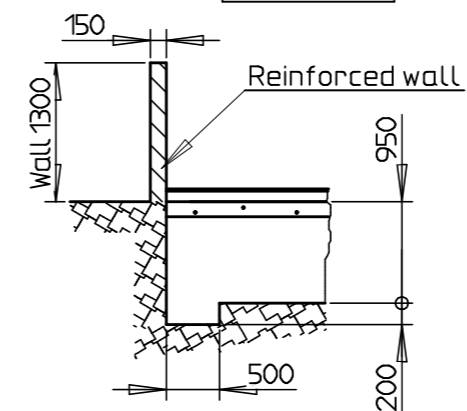

Please note!
 Ventilation:
 During building up there must be provided the necessary ventilation to prevent condensed water in the milking parlor.

All measures in mm

STRANGKO A/S		Tolerance:	Overflade:	Hølestat:	150	Vægt:
HORNE, DK-6800 VARDE				Material:		
TLF. +4575260211				Dimension:		
				Beskrivelse:		
				Milking parlor 2x32 parallel with rotor exit		
				Tegningsnummer:		
				07 232 003 01		
Rev.	Refuse	Date	Navn	Original:	Erst. f.:	Bladnummer:
A	Change column	07.12.05	J.L.J.			1
A	Entrance id-railing	07.12.05	J.L.J.			